

Voltage Controlled Temperature Compensated Crystal Oscillators — SMI

SXO-6000C SERIES (TTL/CMOS LOGIC VC TCXO)

STANDARD SMD VCTCXO

SXO-6000C

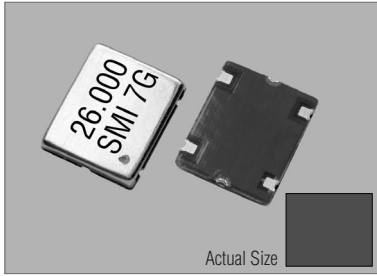

SXO-6000C

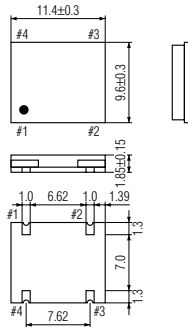

PIN	CONNECTION
1	V _{control}
2	GND
3	OUTPUT
4	V _{cc}

SOLDERING PATTERN

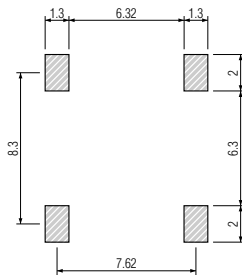

TAPE SPECIFICATIONS

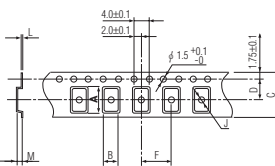

A	B	C	D	F	J	L	M	Reel Dia.	Qty/Reel
12.0	10.2	24.0	11.5	12.0	2.0	0.3	2.3	330 (300)	2000pcs

STANDARD SPECIFICATIONS

H-CMOS VCTCXO

Item	Specifications		
	SXO-6000C(A)	SXO-6000C(B)	SXO-6000C(C)
Part number	SXO-6000C(A)	SXO-6000C(B)	SXO-6000C(C)
Frequency range	9.600000 MHz to 40.000000 MHz		
Initial frequency tolerance	±3.0 ppm (+25°C ±2°C)	±5.0 ppm (+25°C ±2°C)	±10 ppm (+25°C ±2°C)
Frequency stability			
Temperature range	±2.5 ppm max. (-30°C to +75°C)	±5.0 ppm max. (-30°C to +75°C)	±10 ppm max. (-30°C to +75°C)
Input voltage change	±0.3 ppm max.	±0.5 ppm max.	±1.0 ppm max.
Aging (+25°C ±2°C)	±1.0 ppm max. / year	±1.5 ppm max. / year	±3.0 ppm max. / year
Frequency pulling range (min.)	±20 ppm min. (+2.5V ±2V)	±40 ppm min. (+2.5V ±2V)	±60 ppm min. (+2.5V ±2V)
Operating Conditions			
Operating temperature	-30°C to +75°C		
Storage temperature	-30°C to +85°C		
Input voltage (VDD)	N = +5V DC ±0.25V (J = +3V DC ±5%)		
Control voltage (Vcon)	+2.5V DC ±2V (+1.5V DC ±1V)		
Absolute Max. Ratings			
Supply voltage	0V to +7.0V		
Storage temperature	-40°C to +85°C		
Input current	15 mA max.		
Output			
Level	H-CMOS		
Load	5LS-TTL / 15 pF max. (CMOS)		
Startup time	10 ms max.		
Frequency linearity	10% max.		
Frequency slope	Positive		
IR reflow resistance	±1.0 ppm max.		
Reflow condition	+250°C ±10°C for 10 seconds		

PACKAGE DATA

Item	Package	SXO-6000C
Cover		Metal
Base		PCB
Terminal		NiAu
Terminal plating		Gold
RoHS		Compliant (Pb-free)

VCTCXO